

## Coding Card Replacement,

Part No. 7832 264 – 270; 7425 953 – 959

for Vitodens 200-W, type WB2B boilers,  
Part No. 7374 863 – 869

### Safety and Installation Requirements

**Please ensure that these instructions are read and understood before commencing installation. Failure to comply with the instructions listed below can cause product/property damage, severe personal injury, and/or loss of life.**

#### Working on the equipment

The installation, adjustment, service and maintenance of this product must be done by a **licensed professional heating contractor** who is qualified and experienced in the installation, service, and maintenance of hot water boilers. There are no user serviceable parts on the boiler, burner or control.

Ensure **main power** supply to equipment, the heating system, and all external controls has been **deactivated**.

**Close main fuel supply valve.** Take precautions in both instances to avoid accidental activation of power during service work.

It is not permissible to perform service work on any component part without ensuring safe operation of the heating system. When replacing parts, use original Viessmann or Viessmann approved replacement parts.



*Ensure that the installation literature of applicable boiler is referenced.*

### Enclosure Removal

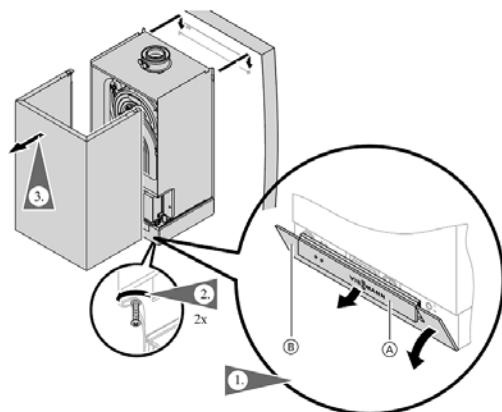

1. Open hinged cover of the control unit (by exerting slight pressure with fingertip). Lift cover A and pivot control unit flap B down. All boiler controls are located behind the control unit flap.

2. Loosen the screws at the bottom of the boiler; do not remove completely.

3. Remove front enclosure panel (lift up and pull towards you).

# Coding Card Replacement

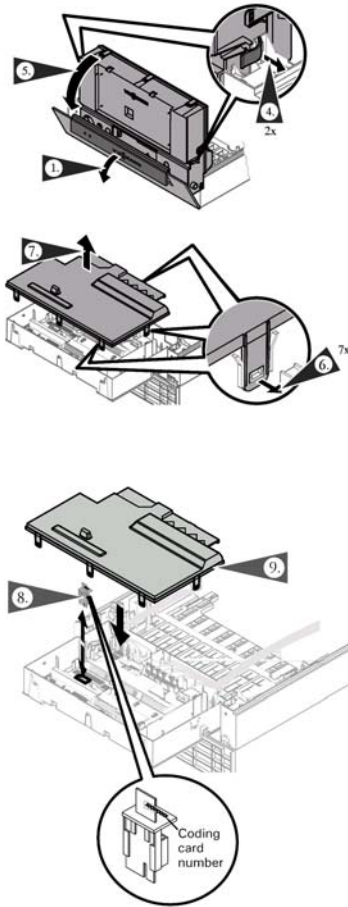

Altitude coding cards

Model Number	Coding card number	
	0-5,000 ft. / 0-1,500 m	5,000-10,000 ft. / 1,500-3,000 m
Vitodens 200-W WB2B 19 kW	7832264 *	7425953
Vitodens 200-W WB2B 26 kW	7832265 *	7425954
Vitodens 200-W WB2B 35 kW	7832266 *	7425955
Vitodens 200-W WB2B 45 kW	7832267 *	7425956
Vitodens 200-W WB2B 60 kW	7832268 *	7425957
Vitodens 200-W WB2B 80 kW	7832269 *	7425958
Vitodens 200-W WB2B 105 kW	7832270 *	7425959

\* Factory Installed

4. Release the red hinged hooks located on both sides of the control unit.

5. Fold down the control unit.

6. Release locking tabs as shown.

7. Remove cover.

*In delivered condition, the boiler is equipped for use of up to 5,000 ft. / 1,500 m. For use in higher altitudes, the control has to be converted. The coding card in the control unit needs to be replaced with the appropriate coding card.*

## Note:

The coding card is located on the left side of the control.

8. Pull out the existing coding card and cut and remove from the cable tie. Insert the high altitude coding card into the boiler control board.

9. Install cover.

Printed on environmentally friendly (recycled and recyclable) paper.

Technical information subject to change without notice.

08/2009

5418958 v 1.0

Viessmann Manufacturing Company (U.S.) Inc.  
45 Access Road  
Warwick, Rhode Island • 02886 • USA  
1-800-288-0667 • Fax (401) 732-0590  
www.viessmann-us.com • info@viessmann-us.com

Viessmann Manufacturing Company Inc.  
750 McMurray Road  
Waterloo, Ontario • N2V 2G5 • Canada  
1-800-387-7373 • Fax (519) 885-0887  
www.viessmann.ca • info@viessmann.ca